



GS Dropbox upload & download bundle (version 4)

The GS Dropbox upload & download bundle provides you with two apps: GS Dropbox upload and GS Dropbox download.

GS Dropbox upload

Upload any file or folder to your Dropbox cloud storage. GS Dropbox upload creates a reusable dataset and private data keys on the fly for use in your Switch workflow. The dataset will also be saved as an XML file via a Log connection. In addition, GS Dropbox upload can optionally create a Dropbox shared download link, which will be added to the dataset, private data keys and XML file.

GS Dropbox download

Use the dataset, private data keys or XML file created with GS Dropbox upload to download the uploaded file or folder. To keep your Dropbox account clean, it is possible to remove the downloaded file or folder automatically after a successful download.

GS Dropbox upload request (from version 4)

Use Dropbox as your business upload portal, providing your customers a simple and easy way to upload their files. Simply create a file request, email the link to your customer and let them upload their files using only their browser.

The upload screen, as provided below, can be somewhat personalized by using a title and a description. You can also set a deadline on the upload portal.

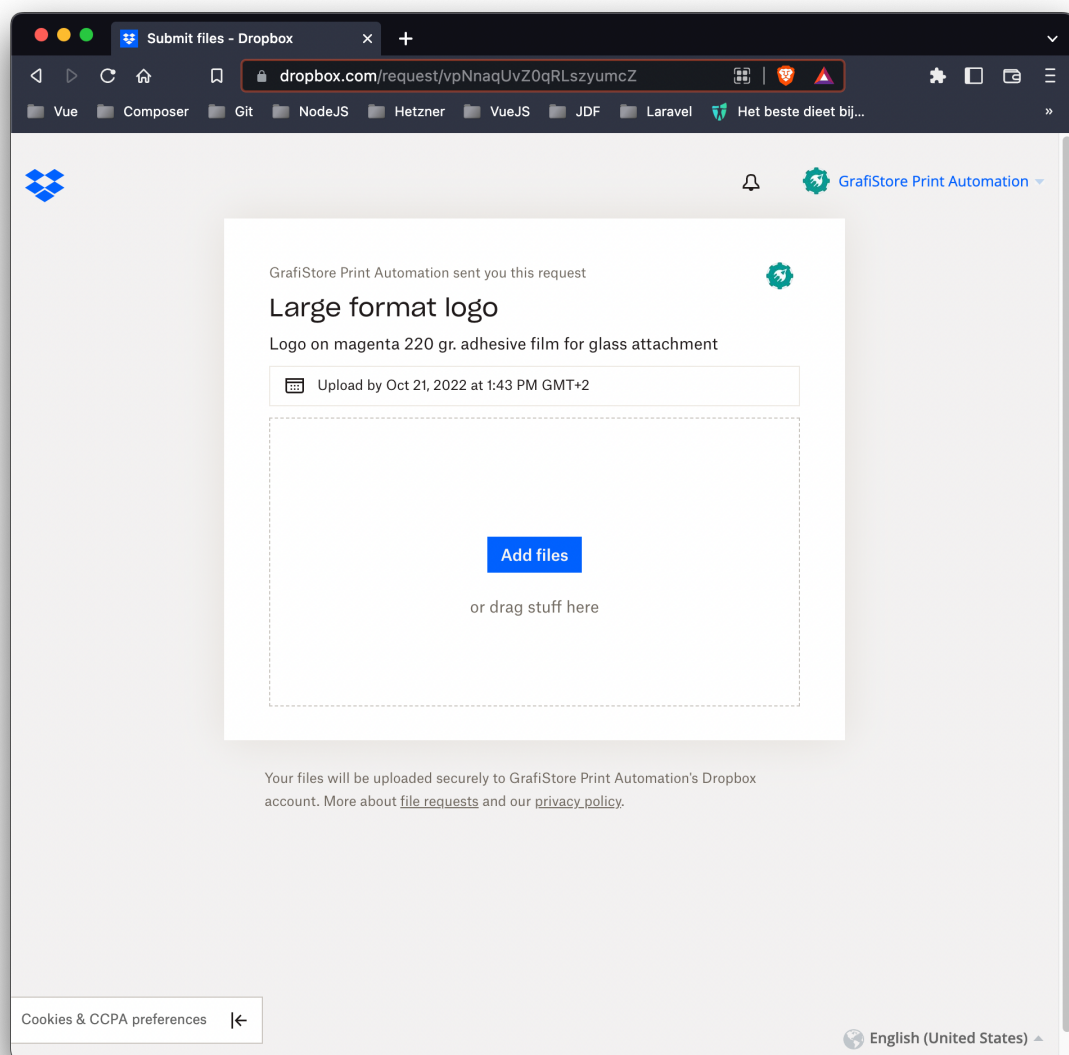

Compatibility version 3

Switch version 2021 Spring
Platform: Windows & Mac.

Compatibility from version 4

Switch version 2022 Spring
Platform: Windows & Mac.

Connections

Dropbox upload has two outgoing connections: One data success out and one log success out. After a successful upload, the uploaded file or folder is moved to the data success out and the XML file with Dropbox file and path data is send to the log success out. Both the input file/folder and the xml have the dataset and private data attached.

Dropbox download has two outgoing connections: One data success and one data error. When successfully downloaded, the file or folder and the input xml file will be moved to data success out. If the download fails, the input xml file will be moved to the data error out connection.

Dropbox upload request has two outgoing connections: One data success and one data error. When an upload request has successfully been created, the job will have an additional dataset that holds all data regarding the upload request.

Samples

GS Dropbox upload sample

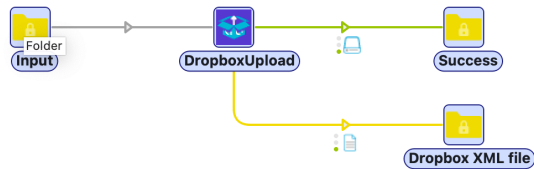

2: GS Dropbox download sample

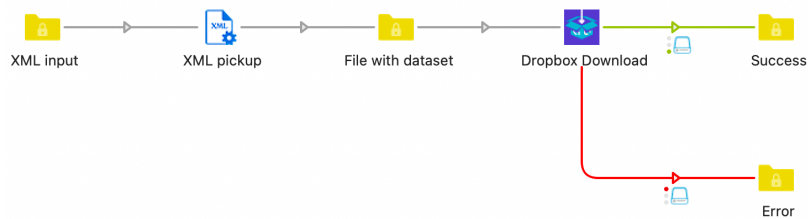

3: Dropbox upload request sample

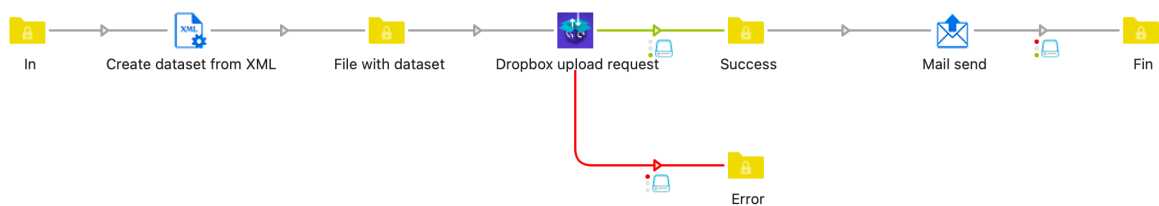

Security: Generating the Dropbox access token

To retrieve an access token, two steps must be taken. The first step is authorizing the Dropbox Upload and Download App to connect to your Dropbox account.

Please visit: <https://dropbox.grafistore.nl>

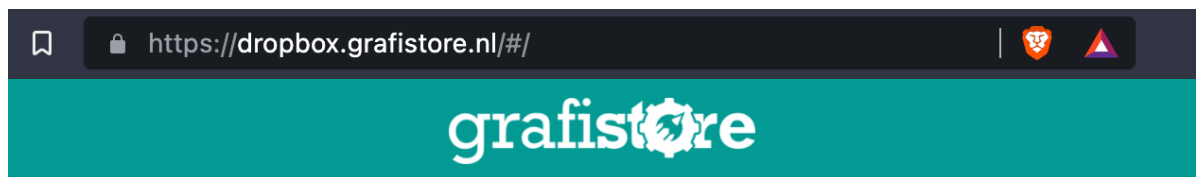

Authorize GS Dropbox

First of all, you need to link your Dropbox account to our Enfocus App. Click on the link below and authorize the GS Dropbox App.

After authorizing the Dropbox App, copy the generated key and click 'Generate token' below.

 [Authorize App](#)

GENERATE TOKEN

 Paste key and generate token

Click on the 'Authorize App'. You will be taken to the Dropbox OAuth2 page where you must grant access to the Dropbox App to access your personal or business Dropbox account.



Upload & Download for Enfocus Switch would like to:

- **Edit** content of your Dropbox files and folders, **view** content of your Dropbox files and folders, and **view and edit** information about your Dropbox files and folders
- **View and manage** your Dropbox file requests and Dropbox sharing settings and collaborators
- **View** basic information about your Dropbox account such as your username, email, and country

Cancel

Allow

[Learn about permissions](#)

You can disconnect apps anytime in [connected apps](#) within your account settings.



Upload & Download for Enfocus Switch would like to:

- **Edit** content of your Dropbox files and folders, **view** content of your Dropbox files and folders, and **view and edit** information about your Dropbox files and folders
- **View and manage** your Dropbox file requests and Dropbox sharing settings and collaborators
- **View** basic information about your Dropbox account such as your username, email, and country

Cancel

Allow

[Learn about permissions](#)

You can disconnect apps anytime in [connected apps](#) within your account settings.

After allowing the App access, an access code is generated.



Access Code Generated

Enter this code into **Upload & Download for Enfocus Switch** to finish the process

MikZAfeBs4AAAAAAAAAMYIEbxU0We7CxxV9IcjH3J5E

Copy this access code and go back to <https://dropbox.grafistore.nl> and click the green button: **Generate Token**. Paste the access key into the destined field and click **Generate Token** once more.



- ✓ Authorize GS Dropbox
- ✎ Paste key and generate token

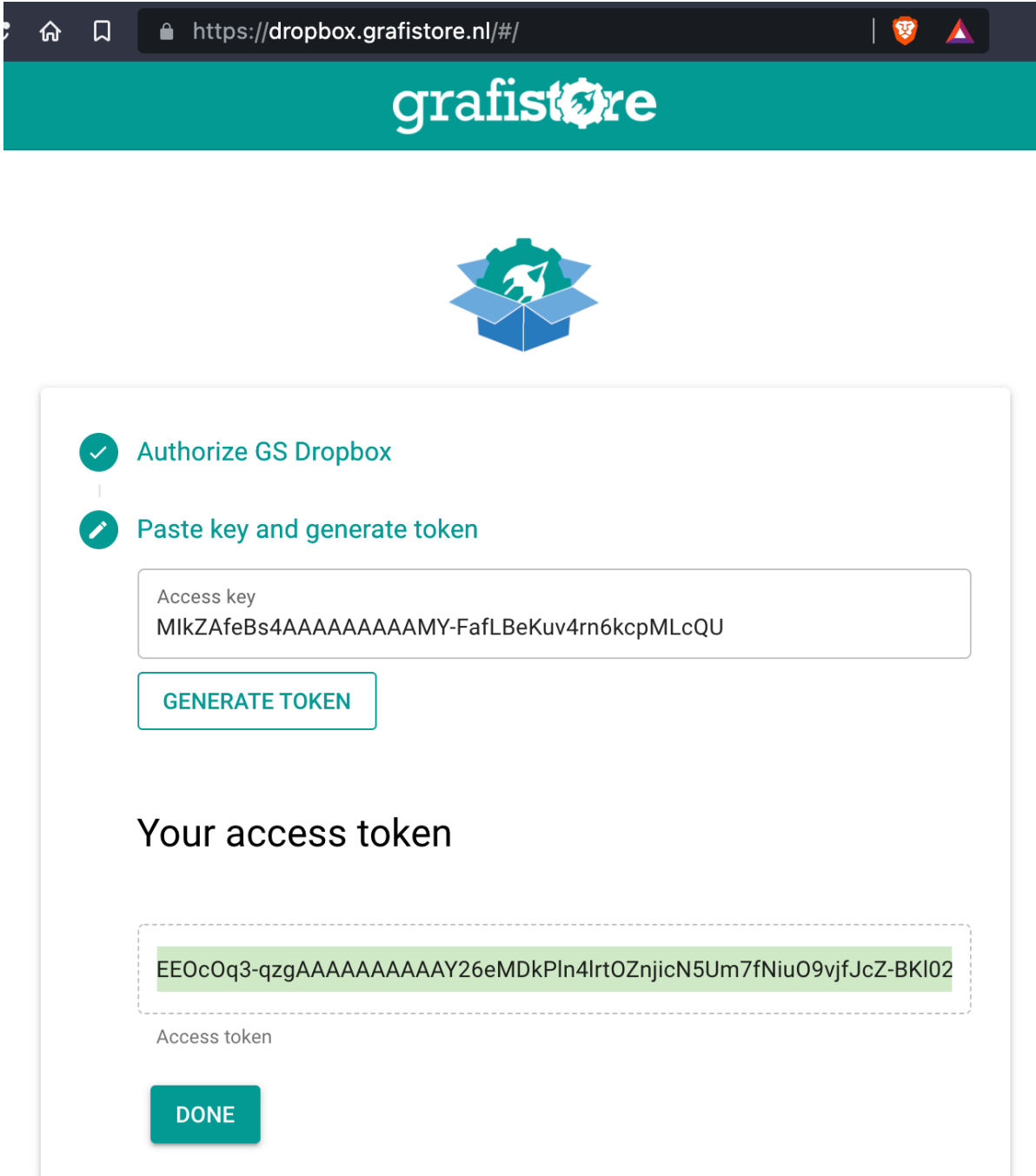

The screenshot shows a web browser window with the URL `https://dropbox.grafistore.nl/#/`. The page features the Grafistore logo at the top. Below the logo is a blue icon of an open box containing a gear and a hand. The main content area is a white box with a light gray border, containing a two-step process:

- ✓ Authorize GS Dropbox
- ✎ Paste key and generate token

Under the second step, there is a text input field labeled "Access key" containing the text: `MlkZAfeBs4AAAAAAAAAMY-FafLBeKuv4rn6kcpMLcQU`. Below the input field is a button labeled "GENERATE TOKEN".

Below the button, the heading "Your access token" is displayed. Underneath, a dashed-line box highlights a green background containing the access token: `EEOcOq3-qzgAAAAAAAAAAAY26eMDkPln4lrtOZnjicN5Um7fNiuO9vjfJcZ-BKI02`. Below this box is the label "Access token" and a button labeled "DONE".

If everything goes well, an access token (refresh token) is generated. This token will be used to create short-lived bearer tokens to access your Dropbox account. Please copy and paste this token in the Upload and/or Download App properties pane.

Note: You can always regenerate an access token by following the steps above!



Configuring Dropbox upload

When using the Dropbox upload, you need to set the required properties in the properties pane.

***** When uploading a folder, subfolders are ignored *****

- **Dropbox remote path:** This is the remote path in which files and folders are stored on your Dropbox account. You can insert any folder name (it will be automatically created) or choose from the list of folders in the root of your Dropbox account.

Good: upload-folder, upload-folder/march, upload-folder/march/Monday, /upload-folder, /UploadSwitch/Files.

- **Access token:** Generate a Dropbox access token and copy into this field. (See: Generating the Dropbox access token.)
- **Create dataset:** Yes/No. If you don't have the Switch Metadata Module, set this to No. You can use the XML file from the upload in the download App.
- **Dataset name:** Name the dataset created by GS Dropbox upload. Default: Dropboxup
- **Create Private Datakeys:** Yes/No. If you don't have the Switch Metadata Module, but, for example, you need the shared link to be emailed.

Private data keys that are generated:

Private data key for path: **filepath**.

Private data key for filename: **filename**.

Private data key for url: **url**.

- **Create shared link:** Yes/No. Whether to create a Dropbox share link (always creates a short url). Will be added to the metadata and XML file



Configuring Dropbox download

When using the Dropbox download, you need to set the required properties in the properties pane.

***** Always use the XML file created with GS Dropbox upload. *****

- **Access token:** Generate a Dropbox access token and copy into this field. (See: Generating the Dropbox access token.
- **Read download info from:** Dataset/XML file/Private data keys. If you don't have the Switch Metadata Module, you can use the XML file or Private data keys to download the file or folder from Dropbox.
- **Remove after download:** Yes/No. Whether to keep or remove the downloaded file in your Dropbox account.



Configuring Dropbox upload request

- **Access token:** Generate a Dropbox access token and copy into this field. (See: Generating the Dropbox access token).
- **Dropbox remote path:** This can be a manually set path (starting with /), chosen from a list read from the root Dropbox folder, or a path set by variables. Setting a path with non-existing folders, will create them automatically for you.
- **Dropbox professional or business:** If you are a paying Dropbox customer (subscribed to business or professional), you'll have the ability to set a deadline to an upload request. Your customer will not be able to upload any file after the deadline. The deadline can be configured to x days.
- **Title of the upload request:** Title will be shown in the Dropbox upload page, so your customer can be informed about the upload request.
- **Description of the upload request:** Can be used to provide more information about the upload.
- **Dataset name:** The name of the dataset containing the Dropbox file request response, with the url to the 'personalized' upload page.

Dropbox upload request will also add a private data key to the job file. This pdk will hold the url to the Dropbox upload request/page.

*Private data key name for upload url: **url**.*

Changelog

##Version 4

Version 3

- Added: OAuth2 short lived tokens for authentication, as suggested by Dropbox
- Added: Token validation in properties pane
- Removed: Long-lived access tokens for authentication, as suggested by Dropbox
- Fixed: Private data key for downloading not working correctly
- Fixed: Creating shared link did not always create a shared link correctly

Version 2

GS Dropbox Upload

- Possibility to upload folders (not zipped)
- No upload file size limit
- Set private data keys (no need for Switch Metatadata module)
- Show upload progress in Messages center

GS Dropbox Download

- Possibility to download folders
- Use the XML file or private data keys provided by GS Dropbox Upload (no need for Switch Metatadata module)
- Removal of folders after download